

REVISIONS		
REV. NO.	DESCRIPTION	DATE

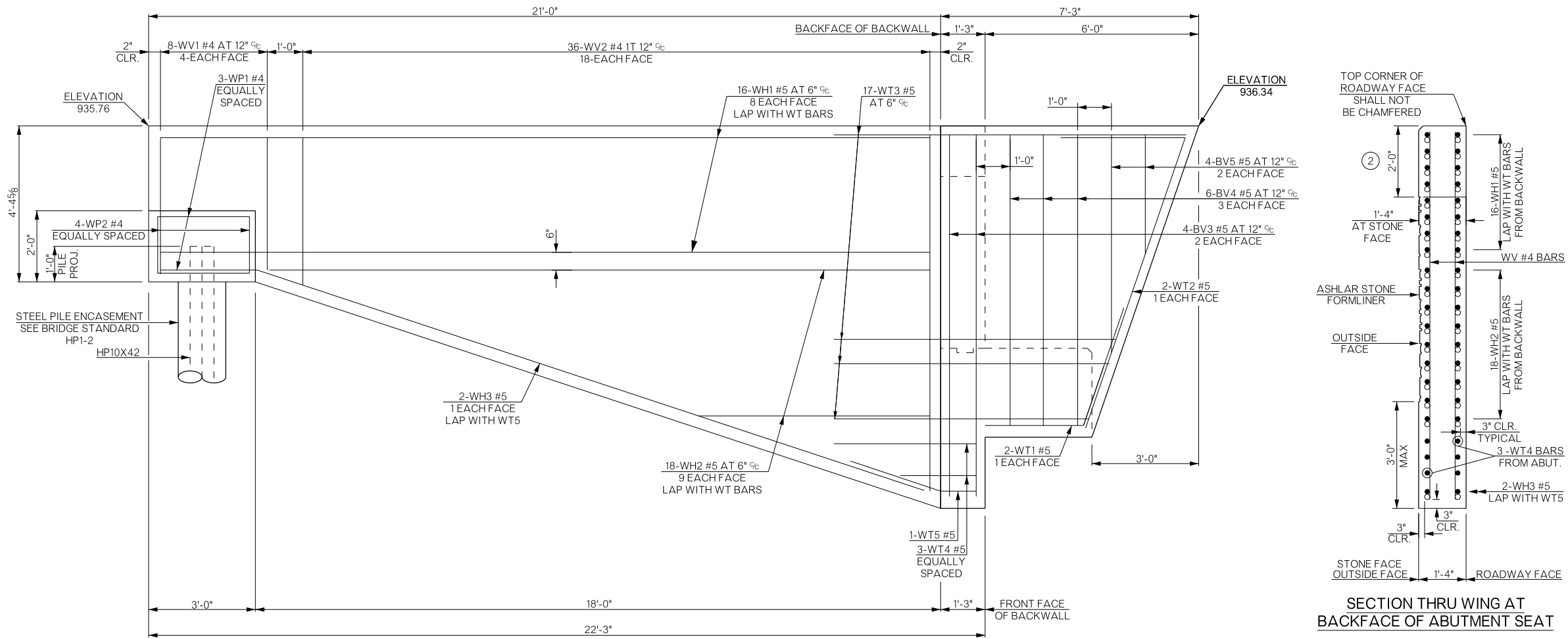

LONGITUDINAL SECTION AT PHASE I OF ABUTMENT NO. 1

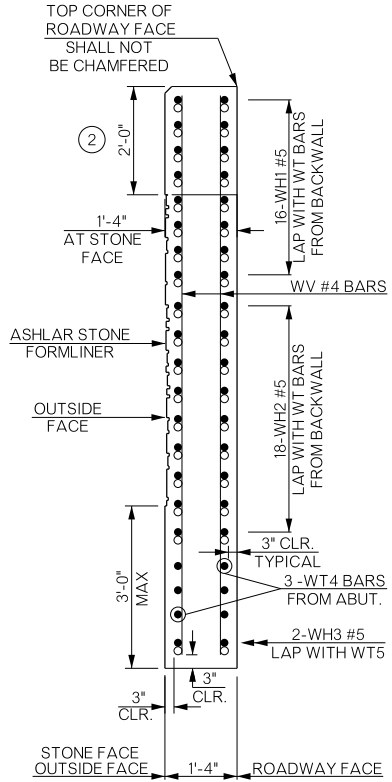

SECTION THRU WING AT BACKFACE OF ABUTMENT SEAT

PHASE I BAR LIST - ABUTMENT NO. 1

MARK	NO.	SIZE	FORM	LENGTH	VARIANCE
EPOXY COATED					
BH1	10	#4	STR.	39'-9"	
BH2	8	#4	BNT.	40'-8"	
BH3	10	#9	STR.	39'-9"	
BH4	18	#4	BNT.	5'-1"	
BV1	37	#4	STR.	9'-4" AVG.	9'-0" TO 9'-8"
BV2	37	#5	STR.	9'-4" AVG.	9'-0" TO 9'-8"
BV3	4	#5	STR.	10'-1"	
BV4	6	#5	STR.	8'-1"	
BV5	4	#5	STR.	4'-3" AVG.	2'-10" TO 5'-8"
WT1	2	#5	BNT.	6'-3"	
WT2	2	#5	BNT.	11'-3"	
WT3	17	#5	BNT.	18'-4" AVG.	15'-6" TO 21'-2"
WT4	3	#5	BNT.	8'-9" AVG.	5'-7" TO 11'-8"
WT5	1	#5	BNT.	8'-6"	
P1	24	#4	BNT.	6'-0"	
P2	16	#4	BNT.	7'-8"	
P3	2	#4	BNT.	14'-11"	
S1	51	#5	BNT.	12'-11"	

PHASE I BAR LIST - ONE WING

MARK	NO.	SIZE	FORM	LENGTH	VARIANCE
EPOXY COATED					
WH1	16	#5	STR.	20'-8"	
WH2	18	#5	STR.	11'-6 1/2" AVG.	5'-8" TO 17'-5"
WH3	2	#5	BNT.	21'-7"	
WV1	8	#4	STR.	3'-11"	
WV2	36	#4	STR.	7'-1" AVG.	4'-3" TO 9'-11"
WP1	3	#4	BNT.	8'-8"	
WP2	4	#4	STR.	1'-7"	

① TWO SETS OF 9 BARS

QUANTITIES - PHASE I - ABUTMENT NO. 1

ITEM	UNIT	TOTAL
SUBSTRUCTURE EXCAVATION COMMON	C.Y.	70.0
CLSM BACKFILL	C.Y.	68.0
CLASS A CONCRETE	C.Y.	38.0
EPOXY COATED REINFORCING STEEL	LB.	4700.0
PILES, FURNISHED (HP 10 X 42)	L.F.	56.0
PILES, DRIVEN (HP 10 X 42)	L.F.	56.0
PILES, FURNISHED (HP 12 X 53)	L.F.	321.0
PILES, DRIVEN (HP 12 X 53)	L.F.	321.0
6" PERFORATED PIPE UNDERDRAIN ROUND	L.F.	39.0
6" NON-PERFORATED PIPE UNDERDRAIN ROUND	L.F.	32.0
WATER REPELLANT (VISUALLY INSPECTED)	S.Y.	54.0

WATER REPELLANT TREATMENT SHALL BE APPLIED TO EXPOSED SURFACES OF THE ABUTMENT INCLUDING: THE TOP OF SEAT, THE BACKWALL, THE PEDESTALS AND PORTIONS OF THE WING WHICH IS EXPOSED.

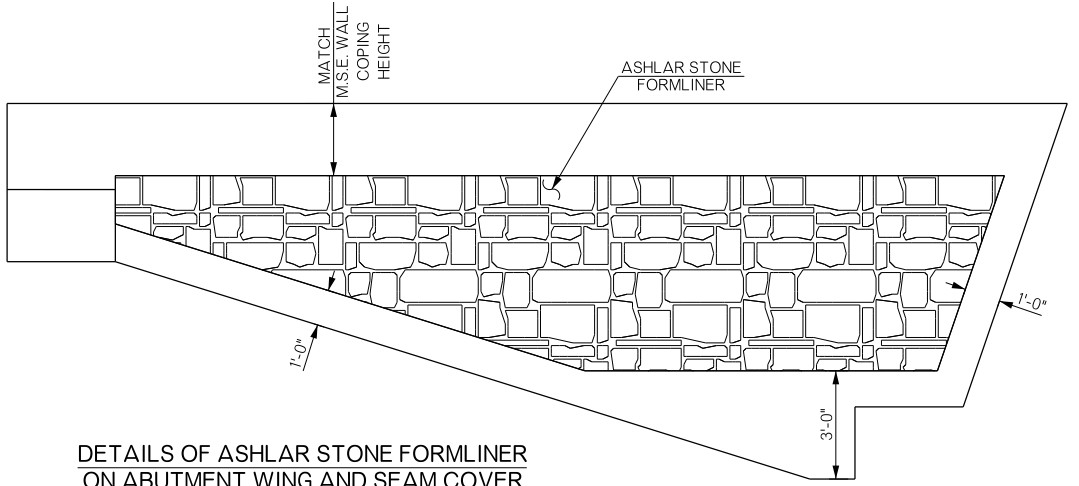

DETAILS OF ASHLAR STONE FORMLINER ON ABUTMENT WING AND SEAM COVER

FOR DETAILS OF AESTHETIC TREATMENTS, SEE SHEET B046

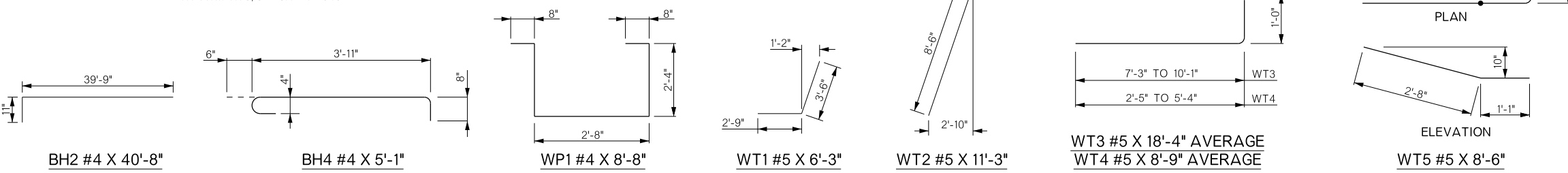

BRIDGE "A"
SH-33 OVER COTTONWOOD CREEK
LOGAN COUNTY

DETAILS OF ABUTMENT NO. 1
(SHEET 3 OF 5)

Design	GT	11/15
Detail	MAP	11/15
Check	TT	8/16

Squad: PEARSON
Eng: HERNANDEZ

STATE OF OKLAHOMA | DEPARTMENT OF TRANSPORTATION
JOB/PROJECT NO. 21860(O4) | SHEET NO. B019